



# The City of Roanoke, VA

**Parcel Id:** 2450207

**Property Address:**

1610 COVE RD NW

ROANOKE, VA 24017



## SUMMARY:

**Mailing Address:**

55 OTTER AVE APT 64

SALEM, VA 24153

**Zoning:** R-7

**Property Acreage:** 0.8166

**Property Sq. Footage:** 35572

**Neighborhood:** 492 - Hershberger South

**Property Frontage:** 311

**Property Class:** 200-SingleFamily

**Property Depth:** 240.00

**Legal Description:** LOT 7 BLK 18 VILLA HGTS

## FLOOD ZONE INFORMATION:

**Special Flood Hazard Area:**

**Firm Panel:** 51161C0161G

**Floodway:**

## OWNERSHIP HISTORY:

Sale Date	Sale Amount	Grantee	Grantor	Document Number
2020-08-18	\$0.00	MOORMAN GERRY - ETALS	MOORMAN JOSEPH C & MARY D	200000465
1999-11-19	\$0.00	MOORMAN JOSEPH C & MARY D	MOORMAN JOSEPH C (Inactive)	0000011938
N/A	\$0.00	MOORMAN JOSEPH C (Inactive)		

## ASSESSMENTS:

Valuation Date	Land Value	Improvement Value	Total Value
2025-01-01	\$40,600.00	\$240,000.00	\$280,600.00
2024-01-01	\$32,600.00	\$220,800.00	\$253,400.00
2023-01-01	\$24,800.00	\$184,900.00	\$209,700.00

2022-01-01	\$17,100.00	\$149,500.00	\$166,600.00
2021-01-01	\$17,100.00	\$131,700.00	\$148,800.00

## RESIDENTIAL DWELLING DETAIL:

Primary Photo:



Primary Sketch:

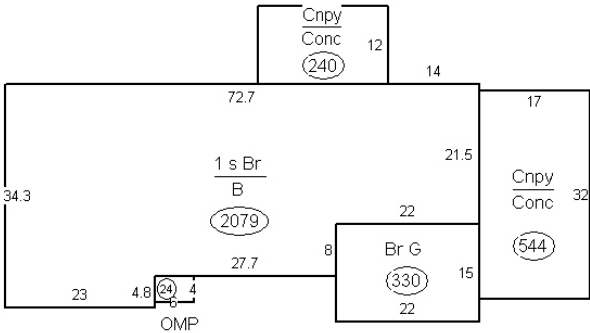

## IMPROVEMENTS:

IMPROVEMENT 1			
1.0 Story			
<b>Structure:</b>		<b>Roof:</b>	
Year Built:	1965	Roof Style:	Hip
Number of Stories:	1.0	Roof Cover:	Comp sh to 235#
Construction Exterior:	Brick veneer	<b>Plumbing:</b>	
Foundation:	Full Bsmt	2 Fixture:	1
Structure:	Wood frame	3 Fixture:	2
Size S/F:	2079	4 Fixture:	0
Lower Split Level/Foyer:	0	5 Fixture:	0
Lower Finished:	0	<b>Heating / Air:</b>	
Total Bedrooms:	3	Heating Type:	Baseboard
Total Rooms:	6	Central Air:	N
<b>Attic:</b>		Fireplaces:	YES
Attic S/F:	None		

Attic Fin S/F: 0	<b>Porches:</b>
<b>Basement:</b>	Enclosed Porch: 0
Basement S/F: 2079	Open Porch: 24
Basement Fin S/F: 0	Wood Deck: 0
<b>Other Improvements</b>	
<b>Garage</b>	
Attached Garage: 330	
Detached Garage:	
Attached Carport:	
Basement Garage:	

