



# COMMONWEALTH of VIRGINIA

## DEPARTMENT OF ENVIRONMENTAL QUALITY

Street address: 629 East Main Street, Richmond, Virginia 23219

Mailing address: P.O. Box 10009, Richmond, Virginia 23240

Fax (804) 698-4500 TDD (804) 698-4021

<http://www.deq.state.va.us>

Dennis H. Treacy  
Director

(804) 698-4000  
1-800-592-5482

James S. Gilmore, III  
Governor

John Paul Woodley, Jr.  
Secretary of Natural Resources

### DIVISION OF WASTE PROGRAM COORDINATION OFFICE OF WASTE PERMITTING

December 8, 1998

Mr. Lawrence C. Musgrove, III  
President  
LCM Corporation  
Post Office Box 13487  
Roanoke, Virginia 24034-3487

DEQ-WCRO

DEC 10 1998

RECEIVED

SUBJECT: LCM Corporation Transfer Station  
Permit-by-Rule #136  
City of Roanoke, Virginia

Dear Mr. Musgrove:

The Department has received your notice of intent to operate a transfer station facility located in the City of Roanoke at 3321 Shenandoah Avenue NW, Roanoke, Virginia 24034. The requirements for this application were completed with the receipt of revised siting certification, design and construction certification and Operational Plan on November 19, 1998.

Attached to this letter are two documents which must not be separated from this letter for compliance purposes. The two documents are:

**ATTACHMENT I: CONDITIONS OF THE PERMIT-BY-RULE STATUS**

**ATTACHMENT II: FACILITY DESCRIPTION**

The purposes of this letter are to acknowledge receipt of the documentation submitted in accordance with the requirements of 9 VAC 20-80-480.E.1 of the Virginia Solid Waste Management Regulations (VSWMR, 9 VAC 20-80-10, et. seq.) for permit-by-rule facilities, and to notify you that Permit-by-Rule #136 is approved. Please note, however, that in accordance with 9 VAC 20-80-480.E.6, and the attached "Conditions of the Permit-by-Rule Status," the Director may require changes in the documents designed to assure compliance with the standards of VSWMR Parts VI and VII, if applicable. Should such changes be accomplished by the facility owner or operator, the Director may require the owner or operator to submit the full application and to obtain a regular solid waste management facility permit.

LCM Corporation  
Page 2

Please note that it is the responsibility of LCM Corporation to obtain any other permits or authorizations that may be necessary. If you have any questions regarding this matter, please contact John P. Godfrey, Environmental Engineer Senior, at (804) 698-4258.

Sincerely,

*Jessie A. Lomanche*

*for* Dennis H. Treacy

Attachments

- c: DEQ - Director, West Central Regional Office
- DEQ - Waste Compliance Manager, West Central Regional Office
- DEQ - E. Paul Farrell, Jr., Waste Permitting
- DEQ - J. Godfrey, Waste Permitting

**ATTACHMENT I**  
**CONDITIONS OF THE PERMIT-BY-RULE STATUS**

**I. CHANGE OF OWNERSHIP**

A permit-by-rule may not be transferred by the permittee to a new owner or operator. However, when the property transfer takes place without proper closure, the new owner shall notify the Department of the sale and fulfill all the requirements contained in 9 VAC 20-80-480.E.1 through 9 VAC 20-80-480.E.3 of the Virginia Solid Waste Management Regulations (VSWMR, 9 VAC 20-80-10, et. seq.) [§§ 7.0.E.1 through 7.0.E.3 of VR 672-20-10] with the exception of those dealing with financial assurance. Upon presentation of the financial assurance proof required by the Financial Assurance Regulations for Solid Waste Facilities (9 VAC 20-70-10, et. seq.) by the owner, the Department will release the old owner from his closure and financial responsibilities and acknowledge existence of the new permit-by-rule in the name of the new owner.

**II. FACILITY MODIFICATIONS**

The owner or operator of a facility operating under a permit-by-rule may modify its design and operation by furnishing the Department a new certificate prepared by the professional engineer and a new operational plan. Whenever modifications in the design or operation of the facility affect the provisions of the approved closure plan, the owner or operator shall also submit an amended closure plan.

**III. LOSS OF PERMIT-BY-RULE STATUS**

In the event that a facility operating under a permit-by-rule violates any applicable siting, design and construction, or closure provisions of Part VI [9 VAC 20-80-310 - 480], the owner or operator of the facility will be considered to be operating an unpermitted facility as provided for in § 2.6 [9 VAC 20-80-80] of VSWMR and shall be required to either obtain a new permit as required by Part VII [9 VAC 20-80-480 - 620] or close under Part V [9 VAC 20-80-240 - 310] or VI [9 VAC 20-80-310 - 480] of these regulations, as applicable.

#### **IV. TERMINATION**

The Director shall terminate permit-by-rule and shall require closure of the facility whenever he finds that:

a. As a result of changes in key personnel, the requirements necessary for a permit-by-rule are no longer satisfied;

b. The applicant has knowingly or willfully misrepresented or failed to disclose a material fact in his disclosure statement, or any other report or certification required under this regulation, or has knowingly or willfully failed to notify the Director of any material change to the information in the disclosure statement;

c. Any key personnel have been convicted of any of the crimes listed in § 10.1 1409 of the Code, punishable as felonies under the laws of the Commonwealth or the equivalent thereof under the laws of any other jurisdiction; or have been adjudged by an administrative agency or a court of competent jurisdiction to have violated the environmental protection laws of the United States, the Commonwealth or any other state and the Director determines that such conviction or adjudication is sufficiently probative of the permittee's inability or unwillingness to operate the facility in a lawful manner.

#### **V. CONDITIONS FOR ISSUANCE**

The herein described activity is to be established, modified, constructed, installed, operated, used, maintained, and closed in accordance with the terms and conditions of this permit and the plans, specifications, and reports submitted and cited in the permit. The facility shall comply with all regulations of the Virginia Waste Management Board (Board). In accordance with Chapter 14, § 10.1 - 1408.1(D) of the Code of Virginia, prior to issuing this permit, any comments by the local government and general public have been investigated and evaluated and it has been determined that the proposed facility poses no substantial present or potential danger to human health and the environment. The permit contains such conditions and requirements as are deemed necessary to comply with the requirements of the Virginia Code, the regulations of the Board, and to prevent a substantial present or potential threat to human health or the environment.

**VI. CERTIFIED OPERATOR**

In accordance with the Virginia Waste Management Act (Title 10.1, Chapter 14 of the Codes of Virginia), § 10.1-1408.2, this facility must employ a facility operator licensed by the Board of Waste Management Facility Operators (Licensing Regulations, 18 VAC 155-20-10 et. seq.).

**VII. RIGHT OF APPEAL**

As provided by Rule 2A:2 of the Supreme Court of Virginia, <sup>4</sup>you have 30 days from the date of the service of this decision to initiate an appeal of this decision, by filing notice with:

Dennis H. Treacy, Director  
Virginia Department of Environmental Quality  
ATTN: Waste Division  
Post Office Box 10009  
Richmond, Virginia 23240-0009

In the event this decision is served to you by mail, three days will be added to that period. Please refer to Part Two of the rules of the Supreme Court of Virginia, which describes the required content of the Notice of Appeal, including specification of the Circuit Court to which the appeal is taken, and additional requirements governing appeals from decisions of administrative agencies.

ATTACHMENT II  
FACILITY DESCRIPTION

COMMONWEALTH OF VIRGINIA  
DEPARTMENT OF ENVIRONMENTAL QUALITY  
DIVISION OF WASTE PROGRAM COORDINATION  
OFFICE OF WASTE PERMITTING  
Permit-By-Rule #136

Facility Name: LCM CORPORATION

Facility Type: TRANSFER STATION      Latitude: 37°58'10" North

Longitude: 79°59'16" West

Site Location: 3321 Shenandoah Avenue NW, Roanoke Virginia

Location Description: The facility is located at 3321 Shenandoah Avenue NW in the City of Roanoke. The LCM Transfer Station consists of two units: an enclosed area for the storage of sealed roll-off containers; and, two box trailers, which shall be kept only in the specifically designated parking area.

Background: LCM Corporation is an environmental services company which is involved in such activities as asbestos and lead paint abatement, and emergency response to petroleum and chemical incidents. As a result of these activities, it is sometimes necessary for LCM Corporation to remove contaminated soil and other media from the incident site before arrangements can be made for treatment or disposal of the materials. The purpose of the LCM Transfer Station is to provide a site for the storage of these materials until they can be transported for treatment or disposal.

Only nonhazardous waste may be managed at the LCM Transfer Station. All materials will be stored in sealed roll-off containers or other sealed containers (drums); asbestos waste will be properly bagged. Roll-off containers will be stored in the enclosed unit only; one box trailer will be specifically designated for the storage of the sealed containers and the other will be used only for the storage of asbestos waste. The hours of operation will be dependent on the requirements caused by the emergency response activities.

The facility is served by all-weather roads, and there is adequate queuing capacity on the LCM property to preclude and interference with traffic on the public roadways. Access to the facility is controlled by a security fence around the LCM property; additionally, the enclosed area and the box trailers shall be locked. Only authorized personnel shall have access to the facility.

Records to be maintained by LCM Corporation shall include the source and quantity of each shipment of incoming waste, date of receipt, any laboratory analyses or MSDS sheets for the material, and the date and destination (treatment or disposal site) for outgoing material.

**Submission Highlights:** The Department is in receipt of an application that contains the following documents:

- A. A notice of intent from Mr. Lawrence C. Musgrove, III, President of LCM Corporation, dated August 28, 1990. A complete disclosure statement was received September 21, 1998. A local government certification, dated June 18, 1998, was signed by Mr. John Thomas Tasselli, Development Review Coordinator, City of Roanoke. These documents are in accordance with 9 VAC 20-80-500.D, and are required submission under 9 VAC 20-80-480.E.1.a.
- B. A document signed by Mr. Richard A. Willet, P.E., and dated November 16, 1998, certifying that the facility conforms to the siting standards of 9 VAC 20-80-340.B. This is a required submission in accordance with 9 VAC 20-80-480.E.1.b. A vicinity map and a site plan were provided.
- C. A document signed by Mr. Richard A. Willet, P.E., dated November 16, 1998, certifying that the facility has been designed and constructed in accordance with the standards of 9 VAC 20-80-340.C. The design of the facility does not include a tipping floor. This is a required submission under ( VAC 20-80-480.E.1.c.
- D. An operational plan entitled "Solid Waste Transfer Station Operations Plan for LCM Corporation" in accordance with 9 VAC 20-80.340.D. This is a required submission under 9 VAC 20-80-480.E.1.d.
- E. A closure plan, entitled "Closure Plan," which meets the requirements of 9 VAC 20-80-340.E. This is a required submission under 9 VAC 20-80-480.E.1.e.
- F. Public participation documents which resulted from the public participation effort, in accordance with 9 VAC 20-80-480.E.5. The advertisement of the public meeting was published in the Roanoke Times newspaper on July 28, 1998, and August 3, 1998. The public meeting was held on August 11, 1998. The record indicated that no questions or comments were received. This is a required submission under 9 VAC 20-80-480.E.1.g.



DEPT OF  
ENVIRONMENTAL QUALITY  
SEP 2 1998  
OWBAM PERMITTING

August 28, 1998

**NOTICE OF INTENT (9VAC 20-80-500)**

Department of Environmental Quality  
629 E. Main St., 4th Flr.  
Richmond, Va. 23219  
804-698-4258  
Attn: Mr. John Godfrey

Re: Application for Permit by Rule: Solid Waste Transfer Station

Dear Mr. Dennis H. Treacy, Director,

Pursuant to 9-VAC 20-80-500, LCM Corporation, (LCM), hereby gives notice of its intent to apply for a permit by rule for the operation of a Solid Waste Transfer Station on its premises at 3321 Shenandoah Avenue, NW, in the city of Roanoke, Virginia.

In connection therewith LCM encloses herewith the following:

1. Disclosure Statement, (Appendix 7.1)
2. Local Government Certification, ( Appendix 7.2)
3. Certificate for Siting Standards as required by 9 VAC 20-80-340(C)
4. Certificate of a Registered Professional Engineer, 9 VAC 20-80-340(C)
5. Operational Plan, 9 VAC 20-80-340(D)
6. Closure Plan, 9 VAC 20-80-340(E)
7. Results of Public Participation 10.1 - 1408.1 (B). (4) Code of Virginia

Sincerely Yours,

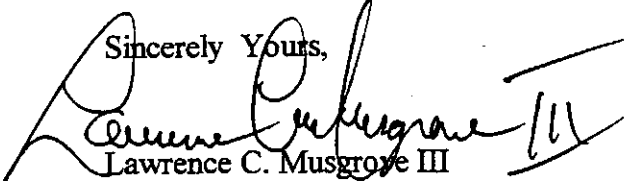

Lawrence C. Musgrove III  
President, LCM Corporation

Revised from 8/12/98



# Brightwaters Engineering

4836 Warrior Drive  
Salem, Virginia 24153  
540-380-2944

DEPT OF  
ENVIRONMENTAL QUALITY  
NOV 19 1998  
CUSTOM REGISTRATION

November 16, 1998

Mr. John Godfrey  
Virginia Department of Environmental Quality  
P. O. Box 10009  
Richmond, Virginia 23240-0009

This is to certify that the siting, design, construction, and operation of the proposed LCM Corporation Solid Waste Transfer Station, 3321 Shenandoah Avenue, Roanoke, Virginia, are in accordance with Virginia DEQ regulations (9-VAC 20-80-340), and is suitable from an engineering standpoint for the intended use.

Specifically -

- the proposed solid waste transfer facility will have direct access to a paved public right-of-way (Shenandoah Avenue);
- the proposed solid waste transfer facility will not be located within any area subject to base floods, and will not be located within 50 feet of any surface stream;
- the proposed solid waste transfer facility is designed to have safe on-site vehicular access, sufficient for intended traffic volumes;
- the proposed solid waste transfer facility will be not closer than 50 feet to any property line, nor closer than 200 feet to any home, school, or recreation area;
- the proposed solid waste transfer facility includes a private accessway with all-season surface suitable for anticipated vehicle loads from the public right-of-way to the unloading area;
- the proposed solid waste transfer facility is situated within the LCM Corporation compound to allow on-site queuing capacity sufficient for the maximum anticipated vehicular flow to prevent backup of vehicles onto the public right-of-way;

- the proposed solid waste transfer facility will not accept household hazardous wastes,
- the proposed solid waste transfer facility is enclosed under roof, with a sealed concrete floor with grated floor drain..

Additionally -

- the LCM Corporation compound is completely *secured* with fencing and controlled gate;
- LCM Corporation personnel *only* will deliver solid waste materials;
- materials will arrive on-site in *water-resistant sealed containers*;
- only *non-hazardous* materials will be permitted on-site (clean-up materials from road-spills not permitted to remain in the public right-of-way)
- the proposed solid waste transfer facility will *not* alter any existing drainage patterns/.

For your additional information, no new building or structure is proposed in conjunction with this project.

Please also note that the operation of the facility will be handled in-house by LCM personnel, as will be the eventual closure of the facility.

Thanks for your interest and assistance in this project. Please do not hesitate to contact me if you require additional information prior to endorsement and approval by the DEQ.

Sincerely,

Richard A. Willet, P.E.

LCM CORP.  
321 SHENANDOAH AVE N.W.  
P.O. BOX 13487  
ROANOKE, VA. 24034-3487  
540-344-5583

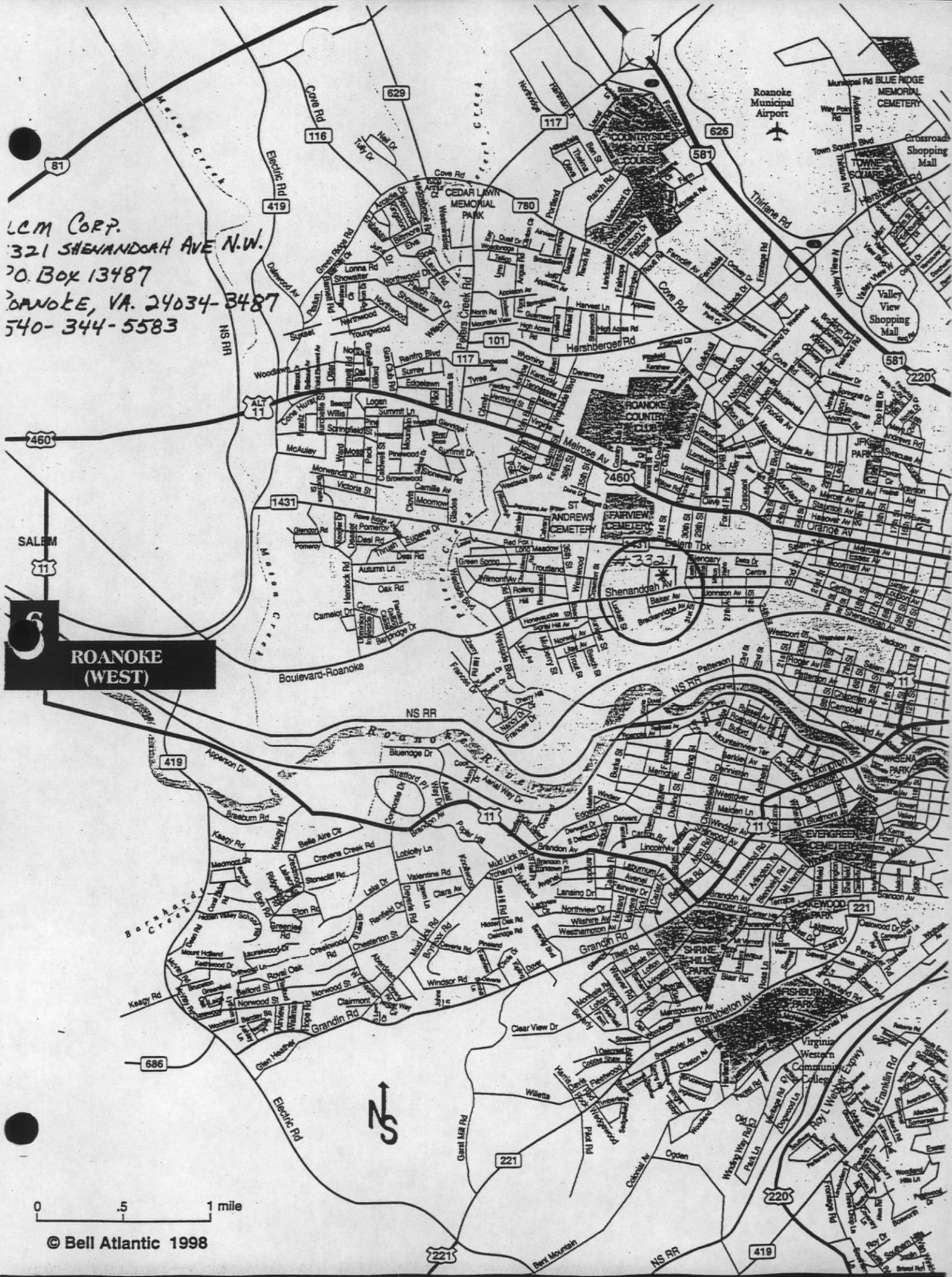

**6**  
**ROANOKE (WEST)**

0 .5 1 mile

© Bell Atlantic 1998

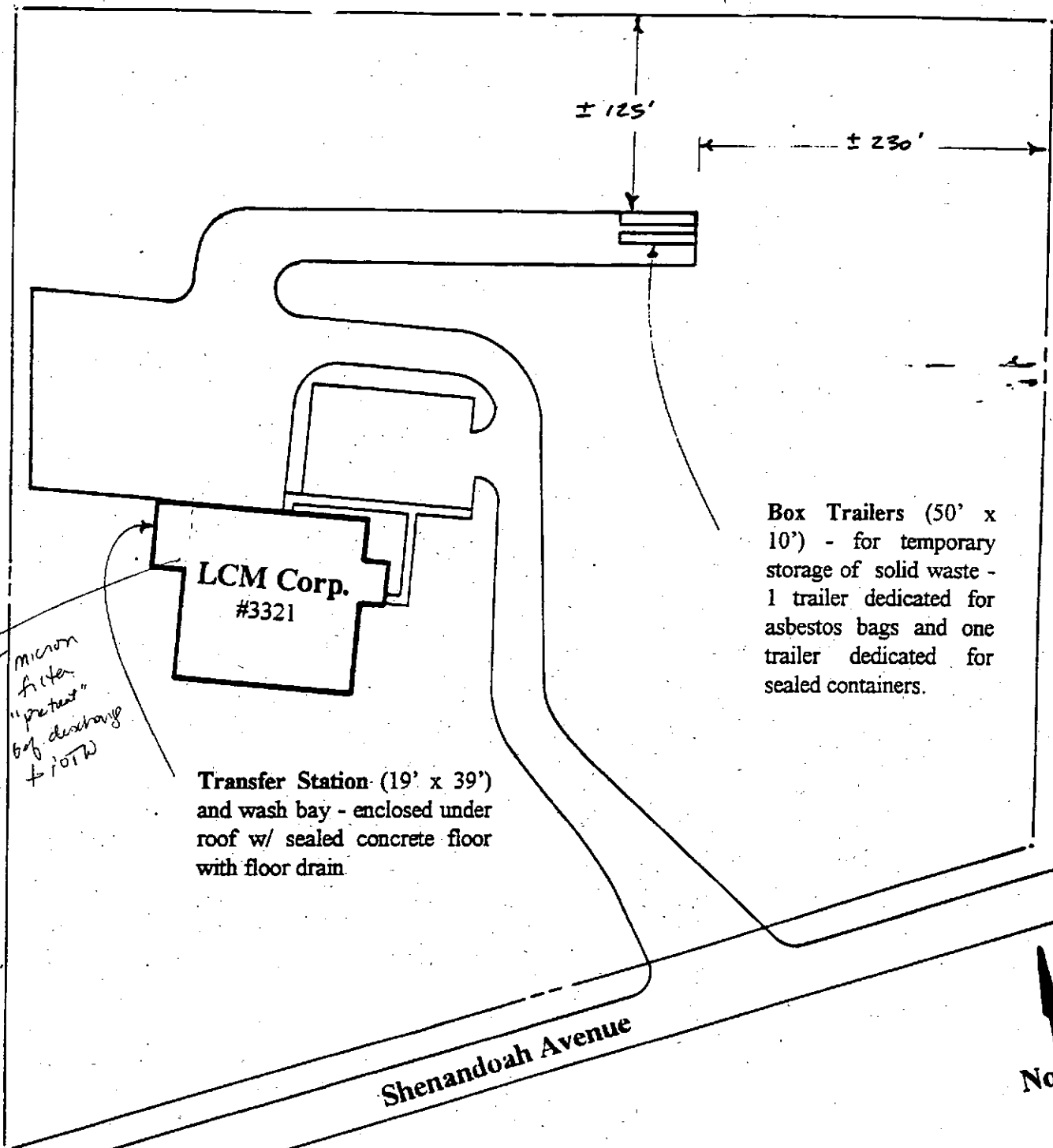

Box Trailers (50' x 10') - for temporary storage of solid waste - 1 trailer dedicated for asbestos bags and one trailer dedicated for sealed containers.

5 micron filter "pre-test" bag discharge + 10TW

Transfer Station (19' x 39') and wash bay - enclosed under roof w/ sealed concrete floor with floor drain.

Shenandoah Avenue



Map Showing

**Proposed LCM Corporation Transfer Station**

Roanoke, Virginia

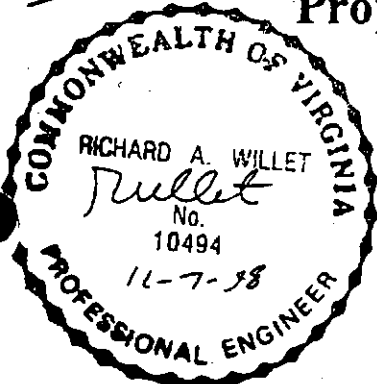

Brightwaters Engineering  
Salem, Virginia 24153  
540-380-2944

November 7, 1998

Scale: 1" = 100 ft.

# Solid Waste Transfer Station

## OPERATIONS PLAN

for

### LCM Corporation

Environmental Services  
3321 Shenandoah Avenue  
Roanoke, Virginia

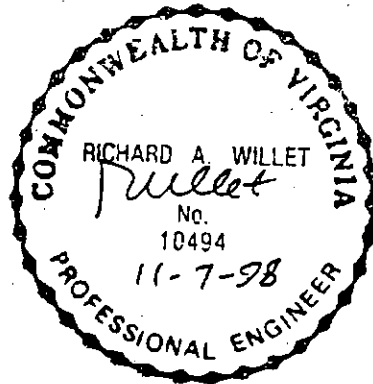

---

Brightwaters Engineering  
Salem, Virginia 24153  
540-380-2944

November 7, 1998

# LCM Corporation

Environmental Services  
3321 Shenandoah Avenue  
Roanoke, Virginia  
540-344-5583

## Solid Waste Transfer Station -

### OPERATIONS PLAN (9VAC-20-80-340D)

#### Background

LCM Corporation (LCM) is an environmental services contractor. LCM operations include industrial cleaning, vacuuming, asbestos abatement, lead abatement, and emergency assistance to oil and chemical spill incidents. LCM performs this work utilizing full-time LCM personnel, LCM owned equipment, and inventoried supplies.

LCM responds to incidents involving non-hazardous materials, including petroleum based products. This work often involves the removal of contaminated soils after regular work hours, or on weekends - meaning LCM would be unable to arrange for the disposal of contaminated soils until the following business day. Leaving such materials on the side of the road within a public right-of-way is not allowed. In consideration of this common scenario, LCM Corporation requests a Transfer Station Permit by Rule for the storage of non-hazardous materials at its facility.

#### Materials Accepted

LCM Corporation will accept solid waste materials for temporary storage only when direct hauling to a landfill is impossible, or when interim storage at the LCM Complex is more feasible than to haul the materials directly to a landfill.

### Allowable Storage Areas

No solid waste will remain at the LCM complex unless it is stored in the designated enclosed Transfer Station, or unless it is stored in an interim transport vehicle (enclosed box trailer) designed and designated for its specific storage.

The enclosed Transfer Station is located under roof with a sealed concrete floor, and grated floor drain eventually discharging into the City of Roanoke sanitary sewer system.

The interim transport vehicle area located at the LCM site shall contain two box trailers - one designated for asbestos bags, clearly and permanently labeled "ASBESTOS" in letters at least 3" high, and the other for sealed containers, clearly and permanently labeled "SEALED CONTAINERS" in letters at least 3" high. The two box trailers shall be placed on a suitable surface, approximately 20 feet by 50 feet, with periphery shall be marked by a 4 foot tall treated wood post located at each corner, painted yellow.

### Access

The proposed solid waste transfer facility, both the enclosed Transfer Station and the interim transport vehicle area, includes a private accessway with all-season surface suitable for anticipated vehicle loads from the public right-of-way to the unloading area. The proposed solid waste transfer facility is situated within the LCM Corporation compound with all weather access-ways. Safe on-site vehicular access is provided, as well as adequate on-site queuing capacity sufficient for the maximum anticipated vehicular flow to prevent backup of vehicles onto the public right-of-way. LCM personnel will be the only users of the facility.

### Siting of Facility

Neither the enclosed Transfer Station nor the interim transport vehicle area shall be located closer than 50 feet to any property line, nor closer than 200 feet to any home, school, or recreation area, nor closer than 50 feet to any surface stream. Neither the enclosed Transfer Station nor the interim transport vehicle area shall affect storm water drainage in any significant way.

### Additional Requirements

All roll-off containers delivered to the LCM complex are to be sealed. Roll-off containers are to be stored in the enclosed Transfer Station. Asbestos bags are to be stored only in the box trailer labeled "ASBESTOS". Sealed containers (drums) are to be stored only in the box trailer labeled "SEALED CONTAINERS". No tipping of materials will be permitted at the LCM solid waste transfer facility.

### Hazardous Wastes

No hazardous waste (as defined by the Virginia Hazardous Waste Regulations), and no other material posing a hazard to LCM personnel or LCM operations will be accepted at the LCM facility. A program will be designed and implemented to detect and prevent shipment of such materials to the LCM facility. The program will at least include collecting records of incoming waste materials, shipper, place of origin of waste materials, lab analysis and/or MSDS sheets, outgoing transports, and final disposal destination.

### Housekeeping and Maintenance

Solid waste storage areas are to be an element in LCD's routine housekeeping efforts, and are to be maintained in a clean order. Each time activities involving equipment are conducted in the Transfer Station or in the trailers, an inspection is to be performed for damage to containers and leakage. Any materials spilled on the concrete floor of the Transfer Station are to be properly cleaned up for proper disposal. In the box trailers, torn or ruptured asbestos bags are to be replaced; any and all spilled asbestos is to be cleaned up and placed in a sealed asbestos bag. Similarly, damaged drums are to be replaced, with any spilled materials properly cleaned up for proper disposal.

Measures shall be taken to control dust and odors to ensure no nuisance or hazard develops. Fugitive dust and mud shall be minimized at all times.

The LCM Transfer Station will be inspected periodically for visible signs of varmints or vector invasion. If any infestation occurs, proper licensed contractors will be summoned.

Dodson Control Service  
733 11th Street, N.W.  
Roanoke, Virginia 24034



The Transfer Station is located within a locked, fenced compound. Key personnel as stated in the Disclosure Statement will have keys and gate opener. All personnel involved with LCM Corporation will be formally trained in the operation and management of the Transfer Station.

Two employees, maximum, are necessary to properly and effectively operate the Transfer Station. However, no employees will be permanently assigned to Transfer Station duties due to the limited activity anticipated.

Safety hazards to operating personnel shall be controlled through an active safety program, and shall be included in the LCM Health and Safety Plan, which is updated and reviewed with employees on a periodic basis. All personnel will be trained in proper preparation, record-keeping, monitoring, and emergency procedures. Emergency response will be initiated with a 911 system telephone call to police, fire, and medical services.

Operational equipment such as backhoes, lighting generators, compressors, pumps, and bulldozers will be utilized from existing LCM inventory. In the event of equipment failure or other unavailability of LCM equipment, equipment will be rented from a readily available vendor.

RENT-ALLS  
11th Street, N.W.  
Roanoke, Virginia 24034

Local are support will be provided by the City of Roanoke Fire extinguishers and telephones are located throughout the LCM complex at locations familiar to all employees, and at all required locations.

Noise disturbance to residential areas is not considered an applicable factor due to the distance between the LCM complex and any residential use.

Finally, the LCM complex is subject to periodic inspections by the various local agencies.

### Environmental Summary

Use of the LCM complex as an solid waste transfer station will not result in leaching of any fluids or discharge of any pollutants into any waters or wetlands. Requirements of the Clean Water Act and the Virginia Pollutants Discharge Elimination system, and the Virginian Quality Standards will be met.

## **LCM Corporation Solid Waste Transfer Station Control Program for Unauthorized Waste**

LCM Corporation's (LCM) transfer station only accepts waste generated by company activities. Although, it is highly unlikely any unacceptable waste will be delivered or accepted by this facility if such an event was to occur then this program is designed to properly handle such an occurrence.

LCM's transfer station cannot accept any waste considered to be hazardous. Only solid waste can be handled by this facility, such as petroleum contaminated materials or asbestos.

LCM employee's assigned to transfer station activities are to be trained to recognize material that may not be acceptable.

If any suspect material is found at the facility then it is to be promptly reported to Lawrence Musgrove III, the facility operator. If the operator is not available then this event is to be reported any supervisor or management.

The suspect material is to be isolated, contained and placed in the wash bay, if appropriate.

The suspect material is to be recorded in the facility's waste log and a separate record made for the Department of Environmental Quality.

The suspect material is to be removed from the facility as soon as practicable, but not to exceed 90 days after discovery, by a person authorized to transport such waste to a facility approved to receive it for treatment, disposal or transfer.

If there are any questions regarding this program, please contact Lawrence Musgrove III.

Pursuant to Va. Code  
10.1-1406.1 B.4  
LCM Corporation intends to  
apply for a permit to operate a  
Solid Waste Transfer Station  
at 3321 Shenandoah Ave NW,  
Roanoke, Va., 24147. A public  
meeting will be held to identify  
issues of concern and to facili-  
tate communication between  
LCM Corporation and any per-  
sons who may be affected by  
the issuance of this permit.  
Meeting will be held on Tues-  
day, August 11, 1998 at 2:00  
PM on site at 3321 Shenan-  
doah Ave NW, Roanoke, Va.  
24147. For further information  
please contact Ruth A. Love-  
lace, Project Manager, LCM  
Corp. at the above address or  
540-344-5583.  
(840318)

# LEGAL NO- TICES

Pursuant to Va. Code  
10.1-1406.1 B.4  
LCM Corporation intends to  
apply for a permit to operate a  
Solid Waste Transfer Station  
at 3321 Shenandoah Ave NW,  
Roanoke, Va., 24147. A public  
meeting will be held to identify  
issues of concern and to facili-  
tate communication between  
LCM Corporation and any per-  
sons who may be affected by  
the issuance of this permit.  
Meeting will be held on Tues-  
day, August 11, 1998 at 2:00  
PM on site at 3321 Shenan-  
doah Ave NW, Roanoke, Va.  
24147. For further information  
please contact Ruth A. Love-  
lace, Project Manager, LCM  
Corp. at the above address or  
540-344-5583.  
(840318)



August 28, 1998

**CLOSURE PLAN (9VAC 20-80-340E)**

LCM Corp. will close this facility in a manner that will minimize the need for further maintenance and controls, minimize or eliminate to the extent necessary to protect human health and the environment, the post closure escape of uncontrolled leachate, surface runoff, or waste decomposition products to the groundwater, surface water, or to the atmosphere.

Closure will take place at any point in the life of the facility and / or at the time of closing the facility to service. The area will be isolated from the environment and all contaminants removed and disposed of, in addition all solid wastes and residuals at the facility will be properly removed. A clean closure and removal of all roll offs to corresponding disposal facilities with proper documentation of decontamination. An environmental survey of the area will be performed upon decision and notification to the Department of Environmental Quality. LCM Corp. shall complete closure activities in accordance with the closure plan and within six months after receiving the final volume of waste. LCM Corp. will post one sign notifying all persons of the closing and prohibit any further waste from being received, and suitable barriers will be installed at the former access to prevent any new waste from being delivered.



August 28, 1998

**RESULTS OF PUBLIC PARTICIPATION EFFORT (VC 10.1-1408.1.B.4)**

**NOTICE PUBLISHED JULY 28, 1998 & AUGUST 3, 1998  
THE ROANOKE TIMES  
201 CAMPBELL AVE SW  
ROANOKE, VA.**

**Pursuant to Va. Code 10.1-1408.1 B.4**

***LCM Corporation intends to apply for a permit to operate a Solid Waste Transfer Station at 3321 Shenandoah Ave NW, Roanoke, Va. 24147. A public meeting will be held to identify issues of concern and to facilitate communication between LCM Corporation and any persons who may be affected by the issuance of this permit. Meeting will be held on Tuesday, August 11th, 1998 at 2:00 PM, on site at 3321 Shenandoah Ave NW, Roanoke, Va. 24147. For further information please contact Ruth A. Lovelace, Project Manager, LCM Corp., at above address or 540-344-5583.***

The public comments were taken prior to filing with the department this notice of intent to apply for the permit by rule for as stated, transfer station, which is required by the Department's Solid Waste Management Regulation. The preceding is the ad that was published in *The Roanoke Times*, Tuesday, July 28, 1998 and Monday, August 3, 1998. This was published as a public notice once each week for two consecutive weeks, *The Roanoke Times* is a newspaper of general circulation serving the locality in which said stated facility is to be located. We received two inquiries concerning the attempt to offer for sale equipment for our "Transfer Station", after explaining our operations plan to them they realized their service's were not applicable to our needs.

A public meeting was held, fourteen days after public notice appeared, on site at 3321 Shenandoah Ave NW, Roanoke, Va., 24017, August 11, 1998 at 2:00 PM in the library of the LCM Corp., there was no response to our meeting. Mr. Richard Willett PE and Ms. Ruth Lovelace, Project Manager, LCM Corp., were in attendance to answer any concerns. The names and address's will be held of the two contacting inquiries, by phone, if any further need for record comes necessary.

# SOLID WASTE MANAGEMENT FACILITY PERMIT APPLICANT'S DISCLOSURE STATEMENT

## COVER SHEET

**Applicant's Name:**  
Lawrence C. Musgrove III

**Company Name:**  
LCM Corporation

**Address:**  
PO Box 13487

**City:** Roanoke      **State:** Va.      **Zip:** 24034-3487  
**Telephone:** (540)-344-5583

**Applicant's Interest:**  
(Check all applicable boxes)

Owner  
 Operator  
 Other (explain):

Enter below the names of all key personnel and the starting page number showing more detail.  
 A separate DWM Form DISC-02 must be completed on each individual listed below.

Key Personnel	Page
1. Lawrence C. Musgrove III	
2. Dalton E. Thompson Jr.	
3. Lawrence Logan	
4. Richard Honeycutt	
5. Ruth A. Lovelace	
6.	
7.	
8.	
9.	
10.	
11.	
12.	

Key Personnel	Page
13.	
14.	
15.	
16.	
17.	
18.	
19.	
20.	
21.	
22.	
23.	
24.	





July 26, 2004

Ms. Rebecca Wright, Environmental Inspector Senior  
Commonwealth of Virginia  
Department of Environmental Quality  
3019 Peters Creek Road  
Roanoke, Virginia 24019

VIA: FACSIMILE AND USPS

Re: PBR#136, LCM Solid Waste Transfer Station

Dear Ms. Wright:

Please find enclosed an amended disclosure statement for the above referenced permit. This amendment reflects the deletion of Ruth A. Lovelace as one of our key personnel.

Thank you for your assistance in this matter.

Very truly yours,

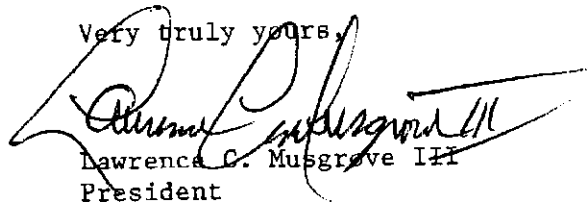

Lawrence C. Musgrove III  
President

Enclosure



**SOLID WASTE MANAGEMENT FACILITY PERMIT  
APPLICANT'S  
DISCLOSURE STATEMENT**

**COVER SHEET**

Applicant's Name:  
Lawrence C. Musgrove III

---

Company Name:  
LCM Corporation

---

Address:  
PO Box 13487

City: Roanoke State: Va. Zip: 24034-3487  
Telephone: (540)-344-5583

Applicant's Interest:  
(Check all applicable boxes)

Owner  
 Operator  
 Other (explain):

Enter below the names of all key personnel and the starting page number showing more detail.  
A separate DWM Form DISC-02 must be completed on each individual listed below.

Key Personnel	Page
1. Lawrence C. Musgrove III	
2. Dalton E. Thompson Jr.	
3. Lawrence Logan	
4. Richard Honeycutt	
5.	
6.	
7.	
8.	
9.	
10.	
11.	
12.	

Key Personnel	Page
13.	
14.	
15.	
16.	
17.	
18.	
19.	
20.	
21.	
22.	
23.	
24.	



# COVER SHEET

List full name and business address of any member of the local governing body or planning commission in which the solid waste management facility is located or proposed to be located, who holds an equity interest in the facility.

Full Name	Business Address
N/A.	

I certify under penalty of law that the information contained in this disclosure statement and all attachments are, to the best of my knowledge and belief, true, accurate, and complete. I am aware that there are significant penalties for submitting false information, including the possibility of fine and imprisonment for knowing violations.

*Lawrence C. Musgrove III*      Lawrence C. Musgrove III, President  
Signature      Typed or printed full name      Title 9/20/92



DWM Form DISC-01

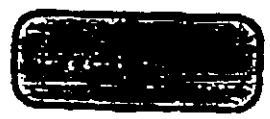

# REQUEST FOR CERTIFICATION

**APPLICANT:**

**APPLICANT'S MAILING ADDRESS:**

LCM Corporation  
P.O. Box 13487  
Roanoke, VA 24034

3321 Shen.  
Ave.

**DATE OF APPLICATION:** 6-18-98

**TELEPHONE:** 540-344-5583

**CONTACT PERSON:**

Doog Witt

**TYPE OF THE FACILITY:**

Environmental

The applicant is in the process of completing an application for a permit for a solid waste management facility to be issued by the Virginia Department of Waste Management. In accordance with Section 10.1-1408.1, Title 10.1, Code of Virginia (1950), as amended, before such a permit application can be considered complete, the applicant has to obtain a certification from the governing body of the county, city or town in which the facility is to be located that the location and operation of the facility are consistent with all applicable ordinances. The undersigned requests that a authorized representative of the local governing body sign the certification below.

**SIGNATURE OF THE APPLICANT:**

*Doog Witt*

**TITLE:**

HAZ-mat-mgr

**NOTE:** The applicant must enclose an appropriate map showing the location of the proposed facility.

## CERTIFICATION

The undersigned certifies that the proposed location and operation of the facility is consistent with all ordinances.

**SIGNATURE OF THE AUTHORIZED REPRESENTATIVE:**

*John Thomas Tasselli*

**TYPED OR PRINTED NAME:** John Thomas Tasselli

**TITLE:** Development Review Coordinator

**DATE:** 6/18/98

**COUNTY, CITY OR TOWN:**

Roanoke City, VA.

