

CURRENT OWNER		2021 ASSESSED VALUE	
T R PROPERTIES INC	Building Value	0	
	Extra Features	0	
P O BOX 3565	Outbuildings	0	
	<b>Total Building Value</b>	<b>0</b>	
MARTINSVILLE VA24115-356	Land Value	6000	
	<b>Total Value</b>	<b>6000</b>	

<b>HENRY COUNTY</b>	
<b>VIRGINIA</b>	
<b>CONSTRUCTION DETAIL</b>	
Element	Description

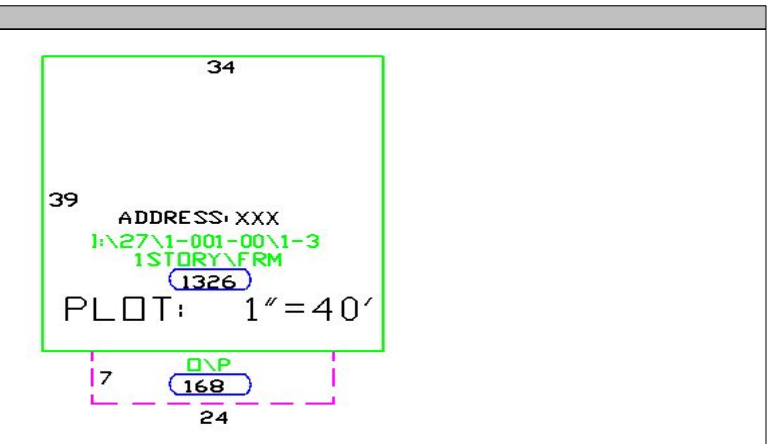

TRANSFER HISTORY	DEED	SALE DATE	QI	SALE PRICE
T R PROPERTIES INC	L0500/07208	12-02-2005	U	50,000

\* 01-01-1900 means date unknown

YEAR BUILT	ASSESSMENT HISTORY		
0	LEGEND	2020	2021
Year 1754 means Date unknown	Building & Extra Features	0	0
	Outbuilding	0	0
	Land	6000	6000
	<b>Total</b>	<b>6000</b>	<b>6000</b>
<b>ZONING</b>			
SR:Suburban Residential			
<b>PROPERTY USE</b>			
00:RESIDENTIAL			
<b>DISTRICT</b>		<b>CLASS CODE</b>	
BB		02:Single Family-Suburb	

STYLE	
Model	Vacant
Stories	
Basement	
Grade	
Grade %	
Roof Cover	
Exterior Wall 1	
Exterior Wall 2	
Interior Floor	
Heat Fuel	
# of Fireplaces	
Central Air %	
Foundation Wall	
Interior Wall	
<b>ROOM COUNT</b>	
Total Bedrooms	
Total Bathroom	
Total Half Baths	

OUTBUILDINGS & HOUSE FEATURES		
Description	Units/Sq Ft	Value

BUILDING SUMMARY			
Code	Description	Living Area	Gross Area

Total Square Foot  
 Living      Gross

Current Sketch

No Sketch

\* I = Outbuildings  
 \*\* B = House Features

LAND FACTORS		LAND VALUATION SECTION														
ROAD	UTILITIES	B	UseDescription	Zone	D	LandUnits	I.Facto	Disc.	C.Fact	NBHD	NBHD	SiteIn	SpecialCalcs	Notes	Unit Price	Land Value
Paved Road	Well Septic	1	SFD - Suburban -			0.318 AC	1.5523	1.000	1.00			1.000	5		16,144.96	6,000
Level	# PARCELS															
MH Lots	2															
0						<b>Total Acres 0.318</b>										
<b>Total Land Value</b>															<b>6,000</b>	

Print Date: 11/10/2021 11:3

TAX MAP # 27.1(001)000 /004A, 5A,6A Acres

PID #: 9398

950 BLACKBERRY RD

Bldg #: Primary Use

ACCT # 058550010

0.274

1 200R

CURRENT OWNER		2021 ASSESSED VALUE	
T R PROPERTIES INC	Building Value	29600	
P O BOX 3565	Extra Features	2300	
	Outbuildings	0	
	<b>Total Building Value</b>	<b>31900</b>	
MARTINSVILLE VA24115-356	Land Value	6000	
	<b>Total Value</b>	<b>37900</b>	

HENRY COUNTY VIRGINIA

CONSTRUCTION DETAIL

1 S BRICK

TRANSFER HISTORY	DEED	SALE DATE	QI	SALE PRICE
T R PROPERTIES INC	L0500/07208	12-02-2005	U	50,000

\* 01-01-1900 means date unknown

YEAR BUILT	ASSESSMENT HISTORY		
1754	<b>LEGEND</b>	<b>2020</b>	<b>2021</b>
Year 1754 means Date unknown	Building & Extra Features	31500	31900
	Outbuilding	0	0
	Land	6000	6000
	<b>Total</b>	<b>37500</b>	<b>37900</b>

MARKET VALUATION		ZONING		PROPERTY USE	
Year remodeled		SR:Suburban Residential		00:RESIDENTIAL	
Market Dep %	55				
Functional Obsl					
External Obslnc					
Condition	OD				
% Complete	43				
Overall % Cond	43				
Dep % Ovr					
Misc Imp Ovr					
Cost to Cure Ovr					
Deprec Code					

OUTBUILDINGS & HOUSE FEATURES		
Description	Units/Sq Ft	Value
B-PORCH OPEN	208	1,500
B-PORCH ENCLOSED	72	800

BUILDING SUMMARY			
Code	Description	Living Area	Gross Area
1ST	1st Floor	1,140	1,140

Total Square Foot  
Living: 1140, Gross: 1140

\* I = Outbuildings  
\*\* B = House Features



LAND FACTORS				LAND VALUATION SECTION												
ROAD	UTILITIES	B	UseDescription	Zone	D	LandUnits	I.Facto	Disc.	C.Fact	NBHD	NBHD	Siteln	SpecialCalcs	Notes	Unit Price	Land Value
Paved Road	Well Septic	1	SFD - Suburban			0.274 AC	1.5735	1.000	1.00			5		3 @ 1800	16,365.44	6,000
TOPO																
Level	# PARCELS															
MH Lots	2															
0						<b>Total Acres 0.274</b>										

**Total Land Value 6,000**