

CURRENT OWNER		2021 ASSESSED VALUE	
T R PROPERTIES INC	Building Value	20800	
P O BOX 3565	Extra Features	1700	
	Outbuildings	4300	
	Total Building Value	26800	
MARTINSVILLE VA24115-356	Land Value	9000	
	Total Value	35800	

HENRY COUNTY
VIRGINIA

CONSTRUCTION DETAIL

1 ST FR

Element	Description
STYLE	Residential
Model	Residential
Stories	1.00
Basement	NONE
Grade	D+5
Grade %	0.90%
Roof Cover	COMP. SH.
Exterior Wall 1	VINYL
Exterior Wall 2	
Interior Floor	CAR & VIN.
Heat Fuel	
# of Fireplaces	
Central Air %	0
Foundation Wall	C/B
Interior Wall	SHEET/PANL



TRANSFER HISTORY		DEED	SALE DATE	QI	SALE PRICE
T R PROPERTIES INC	874/181 (9)	04-11-2000	U	159,000	

* 01-01-1900 means date unknown

YEAR BUILT	ASSESSMENT HISTORY		
1754	LEGEND	2020	2021
Year 1754 means Date unknown	Building & Extra Features	26400	22500
MARKET VALUATION	Outbuilding	0	4300
Year remodeled	Land	9000	9000
Market Dep % 47	Total	35400	35800

ZONING		PROPERTY USE	
A1:Agricultural		00:RESIDENTIAL	
DISTRICT		CLASS CODE	
BB		02:Single Family-Suburb	

OUTBUILDINGS & HOUSE FEATURES		
Description	Units/Sq Ft	Value
I-DRIVEWAY	1	800
I-STORAGE BLDG	288	3,500
B-CARPORT	220	1,700

BUILDING SUMMARY				
Code	Description	Living Area	Gross Area	
1ST	1st Floor	660	660	

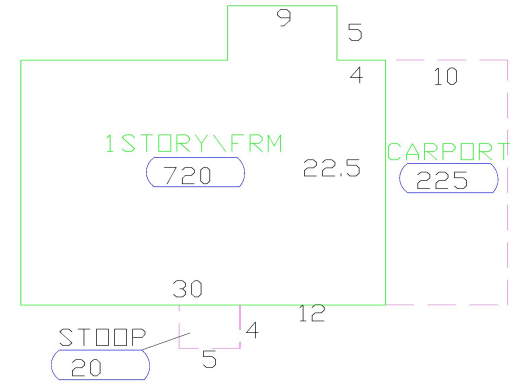

Current Sketch

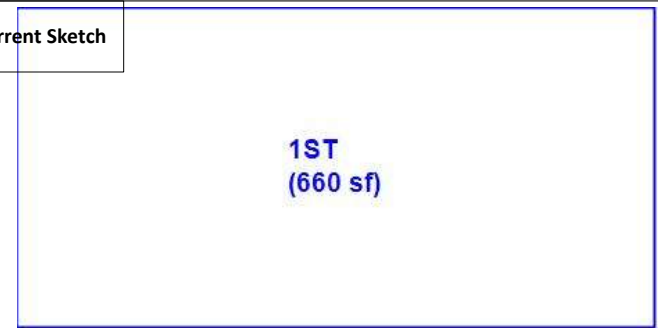

* I = Outbuildings
** B = House Features

LAND FACTORS		LAND VALUATION SECTION														
ROAD	UTILITIES	B	UseDescription	Zone	D	LandUnits	I.Facto	Disc.	C.Fact	NBHD	NBHD	Siteln	SpecialCalcs	Notes	Unit Price	Land Value
Paved Road		1	SFD - Suburban			1.011 AC	0.9901	1.000	1.00		1.000	5			10,298.08	9,000
TOPO																
Level	# PARCELS															
MH Lots	9															
0						Total Acres 1.011										

Total Land Value 9,000