

Property 8



Property Location:

Parcel ID: 106.00-02-62.00-0000
Magisterial District: Cave Spring
Account: 45522
Card 1 of 1

Owner Name and Mailing Address:

SULLIVAN INVESTMENTS LLC
5812 VIEWPOINT AVE SALEM VA 24153

Current Property Assessment 2021

Total Building Value: 0
Total Land Value: 31500
Total Value: 31500



Narrative Description

This property contains 12.00000 AC of land with a(n) N/A style building, Built about N/A, having primary N/A secondary N/A exterior and N/A roof cover, N/A bedroom(s), N/A full bath(s), N/A half bath(s).

Property Characteristics

Jurisdiction:	Roanoke County	Neighborhood:	B057 / STARLIGHT LANE
Legal Description:	BACK CREEK	Census Block:	511610309003039
Deeded Acreage:	12.00000 AC	Land Use Program:	NO
Estimated Acreage:	8.9326 AC		
Vacant Land:	YES		

Sales Information Most Recent Sales

<u>Sale Date</u>	<u>Sale Price</u>	<u>Legal Reference</u>
4/21/2015	7350	DB201503376
3/13/2002	3000	DB0200204810
4/7/1995	3200	DB0014711180
8/1/1991	0	DB0000450803
1/1/1900	0	DB0010720100

Property Location:

Parcel ID: 106.00-02-62.00-0000

Magisterial District: Cave Spring

Account: 45522

Card 1 of 1

Zoning Information

Split:

Zoning Code

County-AG3

Zoning Description

[Agricultural/Rural Preserve](#)

Action No:

Date:

Ordinance:

Name:



Property Location:

Parcel ID: 106.00-02-62.00-0000
Magisterial District: Cave Spring
Account: 45522
Card 1 of 1

Overlay Districts

Emergency Communications: No	Roanoke River Conservation: No
Airport: No	*Manufactured Housing: No
Wellhead Protection: No	Clearbrook Village: No
Floodplain: Yes	

*For more Information on Roanoke County Zoning, please call 540-772-2068 or visit <https://www.roanokecountyva.gov/pz>

Community Number: 510190

Flood Zone Information

<u>Flood Certificates</u>	FIRM Panel: 51161C0261G	Effective Date: 9/28/2007
	Flood Zone: X	Floodway:
	FIRM Panel: 51161C0261G	Effective Date: 9/28/2007
	Flood Zone: 0.2 PCT ANNUAL CHANCE FLOOD HAZARD	Floodway:
	FIRM Panel: 51161C0261G	Effective Date: 9/28/2007
	Flood Zone: AE	Floodway: FLOODWAY
	FIRM Panel: 51161C0261G	Effective Date: 9/28/2007
	Flood Zone: AE	Floodway:
	FIRM Panel: 51161C0261G	Effective Date: 9/28/2007
	Flood Zone: AE	Floodway:
	FIRM Panel: 51161C0261G	Effective Date: 9/28/2007
	Flood Zone: 0.2 PCT ANNUAL CHANCE FLOOD HAZARD	Floodway:

Property Location:

Parcel ID: 106.00-02-62.00-0000

Magisterial District: Cave Spring

Account: 45522

Card 1 of 1

Building Areas

Sub Area

Sketched Area

Finished Area

Perimeter

<u>Sub Area</u>	<u>Sketched Area</u>	<u>Finished Area</u>	<u>Perimeter</u>

Property Location:

Parcel ID: 106.00-02-62.00-0000

Magisterial District: Cave Spring

Account: 45522

Card 1 of 1

Property Location:

Parcel ID: 106.00-02-62.00-0000

Magisterial District: Cave Spring

Account: 45522

Card 1 of 1

Services

Trash Service: [Monday](#)

[Website](#)

Bulk & Brush Pickup: [B Route](#)

Service:

Recycling: [Map](#)

Cox Communications (4.28 miles)

Recreational Center: [Map](#)

Brambleton Recreation Center (4.95 miles)

Police Station: [Map](#)

[Public Safety Center, 5925 Cove Rd, Roanoke VA](#)

Library: [Map](#)

South County Library (2.29 miles)

Fire Station:

[Clearbrook](#)

Schools

Elementary School: [Clearbrook](#)

Middle School: [Cave Spring](#)

High School: [Cave Spring](#)

Property Location:

Parcel ID: 106.00-02-62.00-0000

Magisterial District: Cave Spring

Account: 45522

Card 1 of 1

Broadband Providers

Satellite

<u>Provider Name</u>	<u>Upload Speed</u>	<u>Download Speed</u>
HUGHESNET	Data Not Available	Data Not Available
DISHNET SATELLITE BROADBAND	Data Not Available	Data Not Available
SKYCASTERS	Data Not Available	Data Not Available
VIASAT INC	Data Not Available	Data Not Available

Wireless 4G

<u>Provider Name</u>	<u>Upload Speed</u>	<u>Download Speed</u>
AT&T MOBILITY	Data Not Available	Data Not Available
T-MOBILE	Data Not Available	Data Not Available
US CELLULAR	Data Not Available	Data Not Available
VERIZON WIRELESS	Data Not Available	Data Not Available

Wireless LTE

<u>Provider Name</u>	<u>Upload Speed</u>	<u>Download Speed</u>
AT&T MOBILITY	Data Not Available	Data Not Available
T-MOBILE	Data Not Available	Data Not Available
VERIZON WIRELESS	Data Not Available	Data Not Available

Wireline DSL

<u>Provider Name</u>	<u>Upload Speed</u>	<u>Download Speed</u>
VERIZON VIRGINIA LLC	Data Not Available	Data Not Available

Property Location:

Parcel ID: 106.00-02-62.00-0000

Magisterial District: Cave Spring

Account: 45522

Card 1 of 1

Pictometry



Tax Map

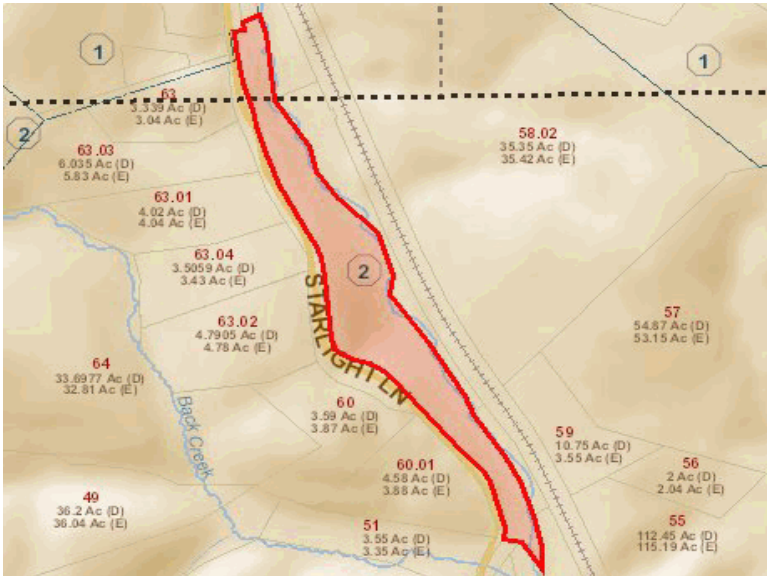

Property Location:

Parcel ID: 106.00-02-62.00-0000

Magisterial District: Cave Spring

Account: 45522

Card 1 of 1

Hybrid

