

Property 3



Property Location: 920 BEDFORD RD
Parcel ID: 060.20-07-15.00-0000
Magisterial District: Vinton
Account: 21736
Card 1 of 1

Owner Name and Mailing Address:
 BONNIWELL JANICE P MOSES
 920 BEDFORD RD VINTON VA 24179

Current Property Assessment 2021

Total Building Value: 56300
Total Land Value: 27600
Total Value: 83900



Narrative Description

This property contains 1 Lot of land with a(n) SINGLE FAMILY RESIDENCE style building, Built about 1921, having primary VINYL OR ALUMINUM exterior and CORRUGATED SHEET METAL roof cover, 2 bedroom(s), 1 full bath(s), 0 half bath(s).

Property Characteristics

Jurisdiction: Town Of Vinton
Legal Description: LT 10 11 & 12 SEC 5 PEDIGO ADD
Deeded Acreage: 1 Lot
Estimated Acreage: 0.317 AC
Vacant Land: NO
Neighborhood: D033 / CENTRAL VINTON - EAST
Census Block: 511610311012002
Land Use Program: NO

Sales Information Most Recent Sales

<u>Sale Date</u>	<u>Sale Price</u>	<u>Legal Reference</u>
5/16/2005	29500	DB0200507444
5/1/2005	0	WB0200200226
1/1/1900	0	PB0000100021
1/1/1900	0	DB0200507443
1/1/1900	0	DB0200507442
1/1/1900	0	DB0200507441

Property Location: 920 BEDFORD RD
Parcel ID: 060.20-07-15.00-0000
Magisterial District: Vinton
Account: 21736
Card 1 of 1

Zoning Information

Split:

Zoning Code
Vinton-R3

Zoning Description
[Residential District](#)

Action No:
Date:
Ordinance:
Name:



Property Location: 920 BEDFORD RD
Parcel ID: 060.20-07-15.00-0000
Magisterial District: Vinton
Account: 21736
Card 1 of 1

Overlay Districts

Emergency Communications: [No](#)
Airport: [No](#)
Wellhead Protection: [No](#)
Floodplain: [No](#)
Roanoke River Conservation: [No](#)
***Manufactured Housing:** [No](#)
Clearbrook Village: [No](#)

*For more Information on Town of Vinton Zoning, please call 540-983-0605 or visit <https://www.vintonva.gov/index.aspx?NID=19>

Community Number: 510190

Flood Zone Information

Flood Certificates **FIRM Panel:** [51161C0169G](#)
Flood Zone: X

Effective Date: 9/28/2007
Floodway:

Building Description

Building Type: SINGLE FAMILY RESIDENCE	Foundation Type: CONTINUOUS FOOTING
Year Built: 1921	Roof Structure: GABLE
Finished Area (SF): 1254	Roof Cover: CORRUGATED SHEET METAL
Style/Story Height: 1.0 STORY	Primary Exterior Wall: VINYL OR ALUMINUM
Bedrooms: 2	Secondary Exterior Wall:
Full Baths: 1	Primary Interior Walls: DRYWALL
Half Baths: 0	Secondary Interior Wall:
Air Conditioning: 100%	Primary Floors: HARDWOOD
Heating: 100%	Secondary Floors:
Heating Type: AIR-NOT DUCTED	Basement Garage:
Heating Fuel: OIL/WOOD/COAL	Fireplace:

Property Location: 920 BEDFORD RD
Parcel ID: 060.20-07-15.00-0000
Magisterial District: Vinton
Account: 21736
Card 1 of 1

Building Areas

<u>Sub Area</u>	<u>Sketched Area</u>	<u>Finished Area</u>	<u>Perimeter</u>
BASE	1254	1254	154
PATIO	112	0	44
PRCH-OP FIN	144	0	60

Property Location: 920 BEDFORD RD
Parcel ID: 060.20-07-15.00-0000
Magisterial District: Vinton
Account: 21736
Card 1 of 1

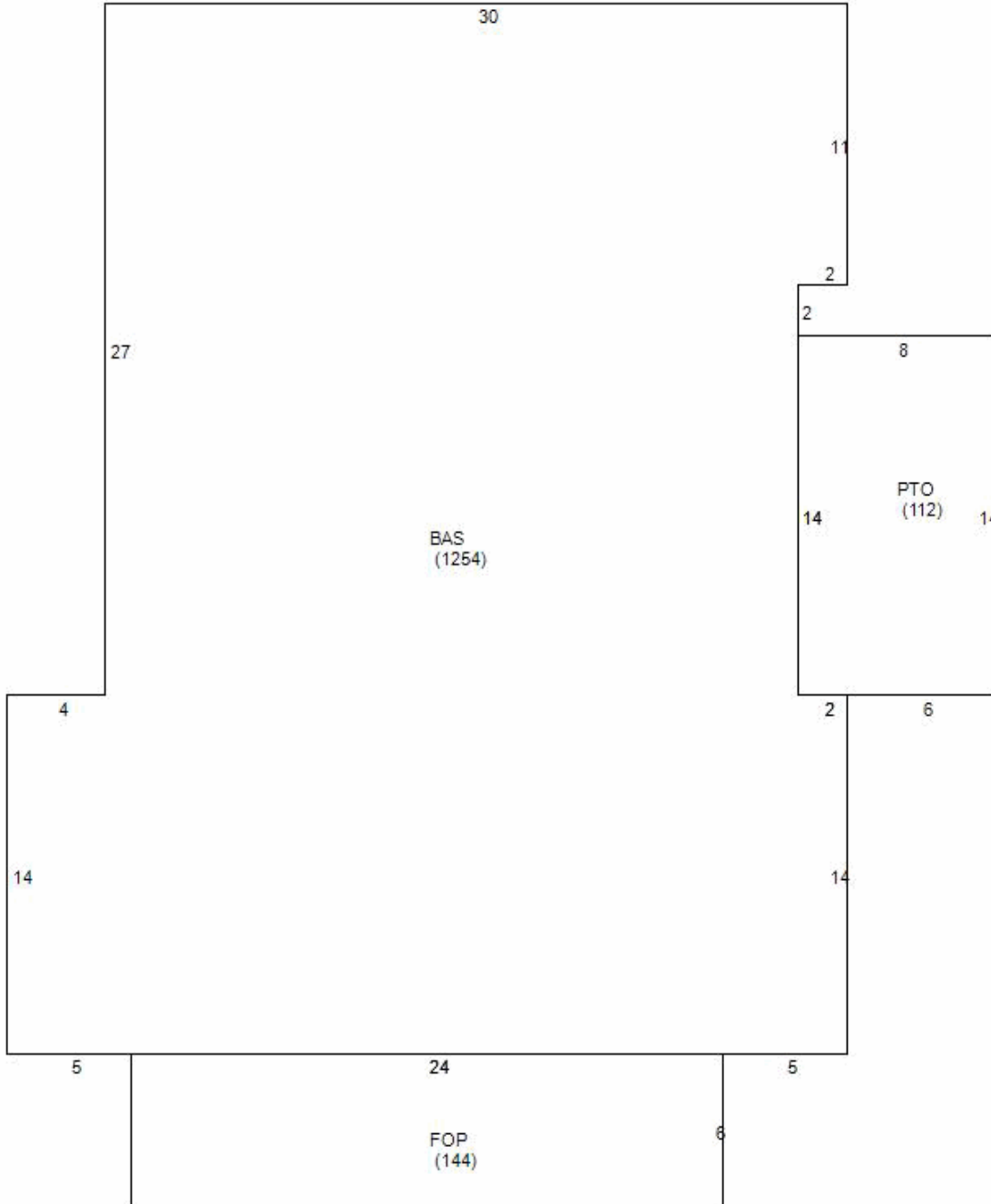

Sum Area by Label:
BAS=1254 (ADJ=1254)
FOP=144 (ADJ=144)
PTO=112 (ADJ=112)

Tot.Area:1510 Tot.Adj.Area: 1510

Property Location: 920 BEDFORD RD
Parcel ID: 060.20-07-15.00-0000
Magisterial District: Vinton
Account: 21736
Card 1 of 1

Services

Trash Service: [Thursday](#)

Bulk & Brush Pickup: [Town Of Vinton](#)

Recycling: [Map](#)

William Byrd Middle (2.10 miles)

Recreational Center: [Map](#)

Craig Avenue Recreation Center (0.67 miles)

Library: [Map](#)

Vinton Branch Library (0.47 miles)

Town of Vinton

[Website](#)

Service: Contact Provider

Police Station: [Map](#)

[Vinton Police, 311 S Pollard St, Vinton VA](#)

Fire Station:

[Town of Vinton](#)

Schools

Elementary School: [Herman Horn](#)

Middle School: [William Byrd](#)

High School: [William Byrd](#)

Property Location: 920 BEDFORD RD
Parcel ID: 060.20-07-15.00-0000
Magisterial District: Vinton
Account: 21736
Card 1 of 1

Broadband Providers

Satellite

<u>Provider Name</u>	<u>Upload Speed</u>	<u>Download Speed</u>
HUGHESNET	Data Not Available	Data Not Available
DISHNET SATELLITE BROADBAND	Data Not Available	Data Not Available
SKYCASTERS	Data Not Available	Data Not Available
VIASAT INC	Data Not Available	Data Not Available

Wireless 4G

<u>Provider Name</u>	<u>Upload Speed</u>	<u>Download Speed</u>
AT&T MOBILITY	Data Not Available	Data Not Available
NTELOS	Data Not Available	Data Not Available
SPRINT	Data Not Available	Data Not Available
T-MOBILE	Data Not Available	Data Not Available
US CELLULAR	Data Not Available	Data Not Available
VERIZON WIRELESS	Data Not Available	Data Not Available

Wireless LTE

<u>Provider Name</u>	<u>Upload Speed</u>	<u>Download Speed</u>
AT&T MOBILITY	Data Not Available	Data Not Available
T-MOBILE	Data Not Available	Data Not Available
US CELLULAR	Data Not Available	Data Not Available
VERIZON WIRELESS	Data Not Available	Data Not Available

Wireline Cable

<u>Provider Name</u>	<u>Upload Speed</u>	<u>Download Speed</u>
COX COMMUNICATIONS	Data Not Available	Data Not Available

Property Location: 920 BEDFORD RD
Parcel ID: 060.20-07-15.00-0000
Magisterial District: Vinton
Account: 21736
Card 1 of 1

Wireline DSL

<u>Provider Name</u>	<u>Upload Speed</u>	<u>Download Speed</u>
VERIZON VIRGINIA LLC	Data Not Available	Data Not Available

Property Location: 920 BEDFORD RD
Parcel ID: 060.20-07-15.00-0000
Magisterial District: Vinton
Account: 21736
Card 1 of 1

Pictometry



Tax Map



Property Location: 920 BEDFORD RD

Parcel ID: 060.20-07-15.00-0000

Magisterial District: Vinton

Account: 21736

Card 1 of 1

Hybrid

