

Alleghany County

VamaNet

Virginia Mass Appraisal Network

Search Locality

[-Home-](#) [-Legal-](#) [-Contact VamaNet-](#) [-Commissioners-](#) [-Localities-](#) [-FAQs-](#) [-About this Site-](#)

Property Information - Tax Map# 05700-00-000-024A - Account# 9094

Property Owner: Nettleton Foundation And Carolton Llc	Legal Description: 5.3977 Ac Paynes Ridge Near Mallow	Zoned: Ar
Owners Address: C/o Moss & Rocovich Att: D Barbour 4415 Electric Road Roanoke, Va 24018	Assessment Values:	
	<u>Building 1</u>	0
	<u>Other Improvements:</u>	0
Total Land Area: 5.3977Acres	<u>Land Value:</u>	16,200
	Calculated Value:	16,200
Physical Location: Not On File	Rounded Taxable Value:	16,200
Magisterial District: Jackson River		

[-Property Information-](#) [-Sales Information-](#)

If you encounter any difficulties with this site, please e-mail the Webmaster.
All rights reserved, Copyright© 2019

TRACT 1

Alleghany County

VamaNet

Virginia Mass Appraisal Network

Search Locality

[-Home-](#) [-Legal-](#) [-Contact VamaNet-](#) [-Commissioners-](#) [-Localities-](#) [-FAQs-](#) [-About this Site-](#)

Acreage Description - Tax Map# 05700-00-000-024A

Description	Size in Acres	Lump Sum/Per Acre	Unit Value	Adj. %	Utility Value	Acreage Value
Other	5.397	Per Acre	3,000	.00	0	16,193
					Total Value:	\$ 16,200
					*rounded to the nearest 100	

[-Property Information-](#) [-Sales Information-](#)

If you encounter any difficulties with this site, please e-mail the Webmaster.
All rights reserved, Copyright© 2019

City of Covington

VamaNet

Virginia Mass Appraisal Network

Search Locality

[-Home-](#) [-Legal-](#) [-Contact VamaNet-](#) [-Commissioners-](#) [-Localities-](#) [-FAQs-](#) [-About this Site-](#)

Property Information - Tax Map# 29--A----2- - Account# 3956

Property Owner: Chase Mary Blakeslee Nettleton	Legal Description: Paynes Ridge 15.82ac Rem	View Sketch (Building 1)
Owners Address: Carolton Llc C/o The Nettleton Foundation P O Box 431 Covington, Va 24426	Prior Assessment:	425,300 Zoned: R1
Total Land Area: 15.82Acres	Assessment Values:	
Physical Location: Not On File	<u>Building 1</u>	265,200
Magisterial District: City Of Covington	<u>Building 2</u>	29,100
	<u>Other Improvements:</u>	20,400
	<u>Land Value:</u>	124,100
	Total Value:	438,800

All Values Rounded to nearest 100

[-Property Information-](#) [-Sales Information-](#)

If you encounter any difficulties with this site, please e-mail the Webmaster.
All rights reserved, Copyright© 2019

City of Covington

VamaNet

Virginia Mass Appraisal Network

Search Locality

[-Home-](#) [-Legal-](#) [-Contact VamaNet-](#) [-Commissioners-](#) [-Localities-](#) [-FAQs-](#) [-About this Site-](#)

Acreage Description - Tax Map# 29--A----2-

Description	Size in Acres	Lump Sum/Per Acre	Unit Value	Adj. %	Utility Value	Acreage Value
Homesite	1.000	Lump Sum	50,000	.00	0	50,000
Wooded	14.820	Per Acre	5,000	.00	0	74,100
					Total Value:	\$ 124,100
					*rounded to the nearest 100	

[-Property Information-](#) [-Sales Information-](#)

If you encounter any difficulties with this site, please e-mail the Webmaster.
All rights reserved, Copyright© 2019

City of Covington

Search Locality

VamaNet

Virginia Mass Appraisal Network

[-Home-](#)
[-Legal-](#)
[-Contact VamaNet-](#)
[-Commissioners-](#)
[-Localities-](#)
[-FAQs-](#)
[-About this Site-](#)

Building Information - Building #1 - Tax Map# 29--A----2-

Exterior Information:

Year Built: 1932
 Occupancy Type: Dwelling
 Foundation: Cinderblock
 Ext. Walls: Brick
 Stucco
 Roofing: Slate
 Roof Type: Gable
 Garage: None
 Carport: None

Interior Information:

Story Height: 2.00
 # of Rooms: 8
 # of Bedrooms: 4
 Full Bathrooms: 3
 Half Bathrooms: 1
 Building Sq. Ft.: 4965
 Basement Sq.Ft.: 2797
 Fin. Bsmt Sq. Ft.: None
 Interior Walls: Drywall
 Floors: Pine
 Heating: F. Air
 A/C: No

Site Information:

Zoning Type: R1
 Terrain Type: Above
 Character: Steep
 Right of Way: Public
 Easements: Paved
 Water: Pub-i
 Sewer: Septic
 Electric: Yes
 Gas: Yes
 Fuel Type: Oil
 Fireplace: 2
 Stacked Fireplace: 1
 Flues: None
 Metal Flues: None
 Stacked Flues: None
 Inop Flue/FP: None
 Gas Log FP: None

[-Property Information-](#)
[-Sales Information-](#)
[-View Sketch-](#)

If you encounter any difficulties with this site, please e-mail the Webmaster.
 All rights reserved, Copyright© 2019

City of Covington

VamaNet

Virginia Mass Appraisal Network

Search Locality

[-Home-](#) [-Legal-](#) [-Contact VamaNet-](#) [-Commissioners-](#) [-Localities-](#) [-FAQs-](#) [-About this Site-](#)

Sketch Index
Map No. 29-A-2-
Building 1

Sect	Type	Stories	SqFt
A	Base Section	2.00	4262
B	Addition	1.00	256
C	Porch	1.00	264
D	Enclosed Porch	1.00	88
F	Addition	1.50	255
G	Addition	.80	192
H	Carport	1.00	240
I	Brick Patio	1.00	240
J	Attic	.40	852

This Sketch only represents the Exterior of the Structure and does not contain any Internal structural details.

Click the image for actual size view.

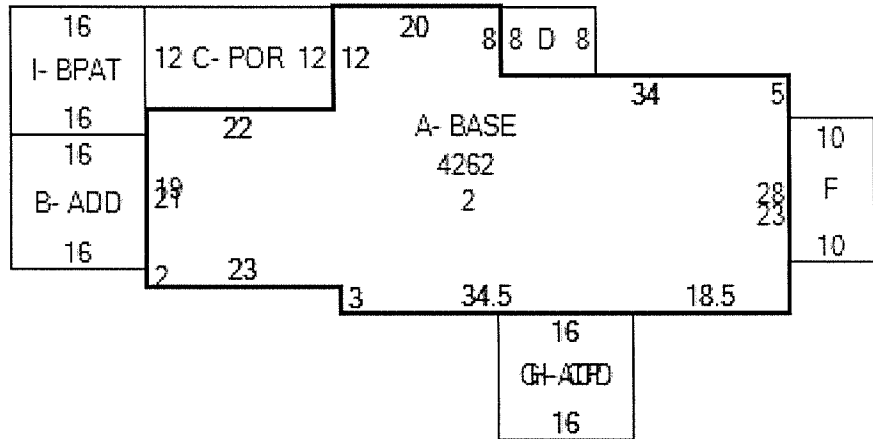

[-Property Information-](#) [-Sales Information-](#)

If you encounter any difficulties with this site, please e-mail the Webmaster.
All rights reserved, Copyright© 2019

City of Covington

VamaNet

Virginia Mass Appraisal Network

Search Locality

[-Home-](#) [-Legal-](#) [-Contact VamaNet-](#) [-Commissioners-](#) [-Localities-](#) [-FAQs-](#) [-About this Site-](#)

Building Information - Building #2 - Tax Map# 29--A----2-

Exterior Information:

Year Built: 1932
 Occupancy Type: Dwelling
 Foundation: Cinderblock
 Ext. Walls: Brick
 Stucco
 Roofing: Slate
 Roof Type: Gable
 Garage: Built-In
 Number of Cars: 3
 Carport: None

Interior Information:

Story Height: 1.00
 # of Rooms: 4
 # of Bedrooms: 2
 Full Bathrooms: 1
 Half Bathrooms: None
 Building Sq. Ft.: 974
 Basement Sq.Ft.: 878
 Fin. Bsmt Sq. Ft.: None
 Interior Walls: Plaster
 Floors: Pine
 Heating: Central
 A/C: No

Site Information:

Zoning Type: R1
 Terrain Type: On
 Character: Rolling/sloping
 Right of Way: Public
 Easements: Paved
 Water: Well
 Sewer: Septic
 Electric: Yes
 Gas: Yes
 Fuel Type: Oil
 Fireplace: 1
 Stacked Fireplace: None
 Flues: None
 Metal Flues: None
 Stacked Flues: None
 Inop Flue/FP: None
 Gas Log FP: None

[-Property Information-](#) [-Sales Information-](#) [-View Sketch-](#)

If you encounter any difficulties with this site, please e-mail the Webmaster.
 All rights reserved, Copyright© 2019

City of Covington

VamaNet

Virginia Mass Appraisal Network

Search Locality

[-Home-](#) [-Legal-](#) [-Contact VamaNet-](#) [-Commissioners-](#) [-Localities-](#) [-FAQs-](#) [-About this Site-](#)

Sketch Index
Map No. 29-A-2-
Building 2

Sect	Type	Stories	SqFt
A	Base Section	1.00	842
B	Addition	2.00	72
C	No Basement Addition	1.00	60

This Sketch only represents the Exterior of the Structure and does not contain any Internal structural details.

Click the image for actual size view.

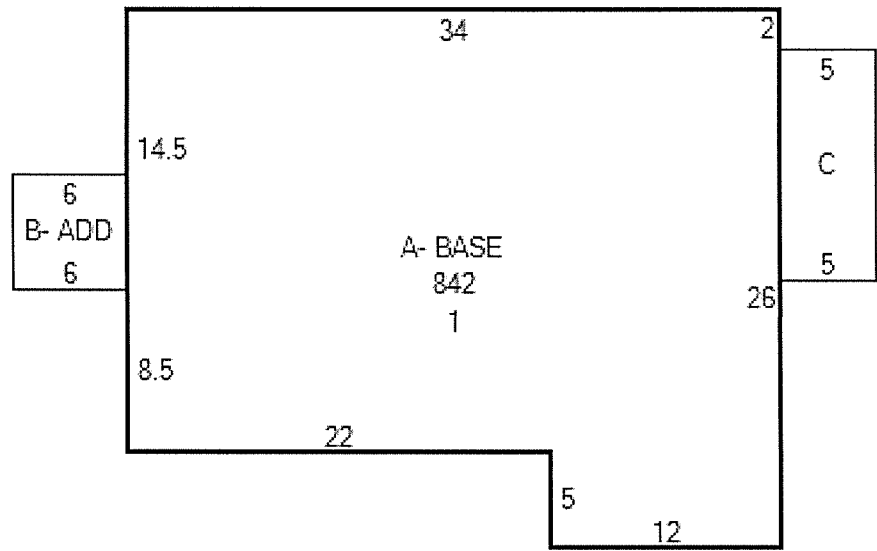

[-Property Information-](#) [-Sales Information-](#)

If you encounter any difficulties with this site, please e-mail the Webmaster.
All rights reserved, Copyright© 2019

City of Covington

VamaNet

Virginia Mass Appraisal Network

Search Locality

[-Home-](#) [-Legal-](#) [-Contact VamaNet-](#) [-Commissioners-](#) [-Localities-](#) [-FAQs-](#) [-About this Site-](#)

Property Information - Tax Map# 29--A---1- - Account# 3955

Property Owner: Nettleton Foundation (the)	Legal Description: Paynes Ridge 70.32 Ac	Zoned: R1
Owners Address: Carolton Llc P O Box 431 Covington, Va 24426	Assessment Values: <u>Building 1</u> 0 <u>Other Improvements:</u> 0	
Total Land Area: 70.32Acres	<u>Land Value:</u> 140,600	
Physical Location: Not On File	Calculated Value: 140,600	
	Rounded Taxable Value: 140,600	
Magisterial District: City Of Covington		

[-Property Information-](#) [-Sales Information-](#)

If you encounter any difficulties with this site, please e-mail the Webmaster.
All rights reserved, Copyright© 2019

City of Covington

VamaNet

Virginia Mass Appraisal Network

Search Locality

[-Home-](#) [-Legal-](#) [-Contact VamaNet-](#) [-Commissioners-](#) [-Localities-](#) [-FAQs-](#) [-About this Site-](#)

Acreage Description - Tax Map# 29--A----1-

Description	Size in Acres	Lump Sum/Per Acre	Unit Value	Adj. %	Utility Value	Acreage Value
Wooded	70.320	Per Acre	2,000	.00	0	140,640
					Total Value: *rounded to the nearest 100	\$ 140,600

[-Property Information-](#) [-Sales Information-](#)

If you encounter any difficulties with this site, please e-mail the Webmaster.
All rights reserved, Copyright© 2019