

UPPER FLOOR PLAN
1/8" = 1'-0"

SPECIFICATIONS - ABBREVIATED
 DIV. 1. GENERAL CONDITIONS: A.I.A. DOCUMENT A201.
 DIV. 2. SITEWORK.
 2-A EARTHWORK: All earth fill shall be CL classification or better and compacted to 95% of max. density. Compaction shall be performed with hand held equipment. Granular fill shall be open graded no. 57 stone.
 2-B SEEDING: All disturbed areas shall be seeded, fertilized and mulched. Seed mixture shall be formulated for the weather conditions at the time of planting.
 2-C STORM DRAINAGE: The contractor shall verify existing conditions and inverts prior to the start of storm drainage work. See plans for extent of work.
 DIV. 3. CONCRETE.
 3-A CAST IN-PLACE CONCRETE: Handling and placement shall conform to A.C.I. 304 and materials shall be: Concrete: 4,000 psi w/ 5% air-entrainment Reinforcing: 60 ksi
 DIV. 4. MASONRY.
 4-A CONC. MASONRY UNITS (CMU): Units shall be lightweight and conform to ASTM C-90 grade M-1.
 4-B MORTAR: ASTM C-270 Type N.
 4-C JOINT REINFORCEMENT: Hot dipped galv. 9 ga. truss type 10" wide.
 DIV. 5. METALS.
 5-A MISC. METALS: Materials as indicated on plans to be ASTM A-36 shop primed.
 DIV. 6. WOOD. (Not used)
 DIV. 7. THERMAL AND MOISTURE PROTECTION.
 7-A MASONRY FILL INSULATION: Fill all hollow CMU cores with "Zonolite" as manuf. by W. R. Grace Inc.
 7-B WATERPROOFING SYSTEM: Install where indicated on plans "Bituthene" as manuf. by W. R. Grace Inc. Materials and installation shall be in strict compliance with the manufacturers specifications to include primers and protection board.
 7-C SEALANTS: One part Acrylic Terpolymer.
 DIV. 8. DOORS AND WINDOWS (Not used)
 DIV. 9. FINISHES.
 9-A MASONRY COATINGS: Install on the exterior Gymnasium portion of the building only; Thoro System "Thoroelastic" per manufacturers specifications to include crack filling.
 END ABBREV. SPEC.

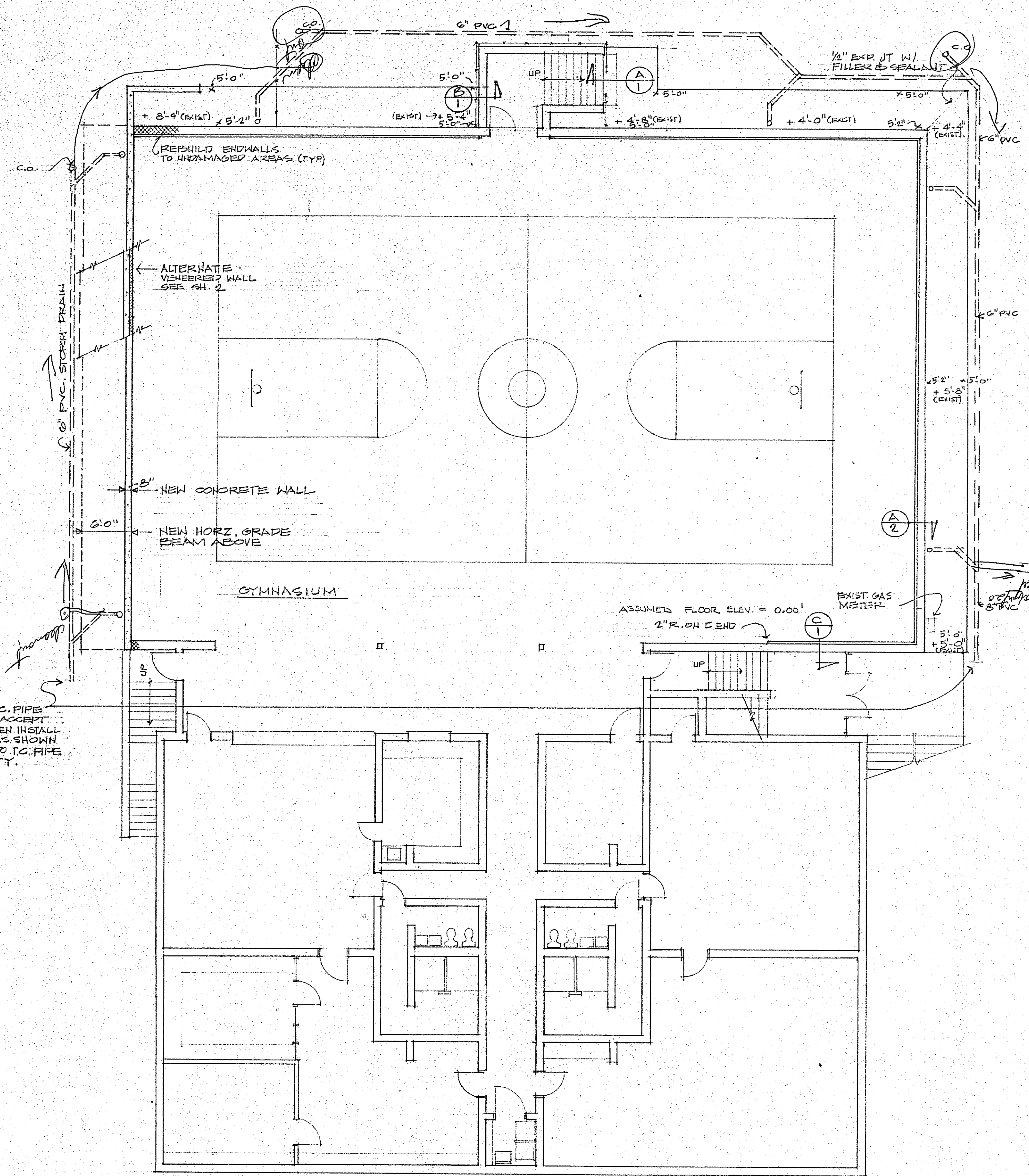

LOWER FLOOR PLAN
1/8" = 1'-0"

PLAN DATA TAKEN FROM PLANS FURNISHED BY THE OWNER AS PREPARED BY E. T. BOGGESS ARCHITECT AND DATED JAN 1968, WITH ADDITIONAL BASEMENT SPACE INDICATED BASED ON FIELD OBSERVATION.

REVISIONS	BY

**FIRST CHURCH OF GOD
 DAY-CARE CENTER**
 5008 HILDEBRAND ROAD, N. W. - ROANOKE, VIRGINIA

RICHARD M. HUGHES
 A.I.A.

ARCHITECTURE
 PLANNING
 CONSULTING

1360 MAPLE AVENUE, S.W.
 ROANOKE, VIRGINIA, 24016

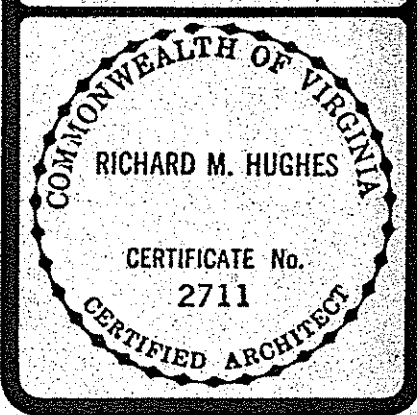

DRAWN JTM/RMH
CHECKED RMH
DATE 2 DEC 85
SCALE NOTED
JOB NO. 8527
SHEET 1
OF 2 SHEETS