



The City of Roanoke, VA

Parcel Id: 1011901

Property Address:

434 CHURCH AVE SW

ROANOKE, VA 24016



SUMMARY:

Mailing Address:

6713 QUEENS RD

ALEXANDRIA, VA 22306

Neighborhood: 855 - Downtown West

Property Class: 400-
Commercial/Industrial

Legal Description: LOT N PT 7 BLK 11 RORER

Zoning: D

Property Acreage: 0.0919

Property Sq. Footage: 4005

Property Frontage: 52

Property Depth: 80.00

FLOOD ZONE INFORMATION:

Special Flood Hazard Area:

Firm Panel: 51161C0164G

Floodway:

OWNERSHIP HISTORY:

Sale Date	Sale Amount	Grantee	Grantor	Document Number
2015-11-02	\$260,000.00	CONNER RUSSELL L III	GRASSHOPPER LLC	150010921
2015-01-16	\$310,000.00	GRASSHOPPER LLC	Multiple Owners	150000385
2000-03-06	\$15,000.00	CONNER RUSSELL L III	CONNER RUSSELL L III ETALS (Inactive)	0000002932
1998-06-03	\$0.00	CONNER RUSSELL L III ETALS (Inactive)	COLLINS BETH A (Inactive)	0980008256
1987-11-19	\$0.00	COLLINS BETH A (Inactive)	HOWARD EDDY D & JERRY J (Inactive)	
1983-02-28	\$48,500.00	HOWARD EDDY D & JERRY J (Inactive)	HELP INC (Inactive)	
N/A	\$0.00	HELP INC (Inactive)		

ASSESSMENTS:

Valuation Date	Land Value	Improvement Value	Total Value
2017-01-01	\$64,700.00	\$153,900.00	\$218,600.00
2016-01-01	\$59,100.00	\$153,900.00	\$213,000.00
2015-01-01	\$59,100.00	\$153,900.00	\$213,000.00
2014-01-01	\$59,100.00	\$153,900.00	\$213,000.00
2013-01-01	\$59,100.00	\$153,900.00	\$213,000.00

RESIDENTIAL DWELLING DETAIL:

Primary Photo:



Primary Sketch:

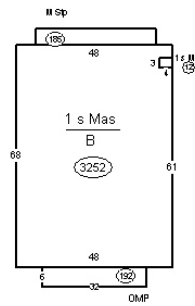

IMPROVEMENTS:

IMPROVEMENT 1

1 Story

Structure:

Year Built: 1940

Number of Stories: 1

Construction Exterior:

Foundation:

Structure: Fire Resistant

Size S/F: 3264

Lower Split Level/Foyer:

Roof:

Roof Style: 1

Roof Cover:

Plumbing:

2 Fixture:

3 Fixture:

4 Fixture:

5 Fixture:

Lower Finished:

Heating / Air:

Total Bedrooms:

Heating Type: 0 sf

Total Rooms: 0

Central Air: N

Attic:

Fireplaces: NO

Attic S/F: None

Porches:

Attic Fin S/F:

Enclosed Porch:

Basement:

Open Porch: 192

Basement S/F: 3252

Wood Deck:

Basement Fin S/F: 0

Other Improvements

Garage

Attached Garage:

Detached Garage:

Attached Carport:

Basement Garage:

PROPERTY MAP:

